

Legend

-  Bike Path
-  Pedestrian Trail
-  Residential
-  Commercial/Hotel
-  Collector Street
-  Regional Arterial
-  Parking Areas
(All residential streets are surface parked.)

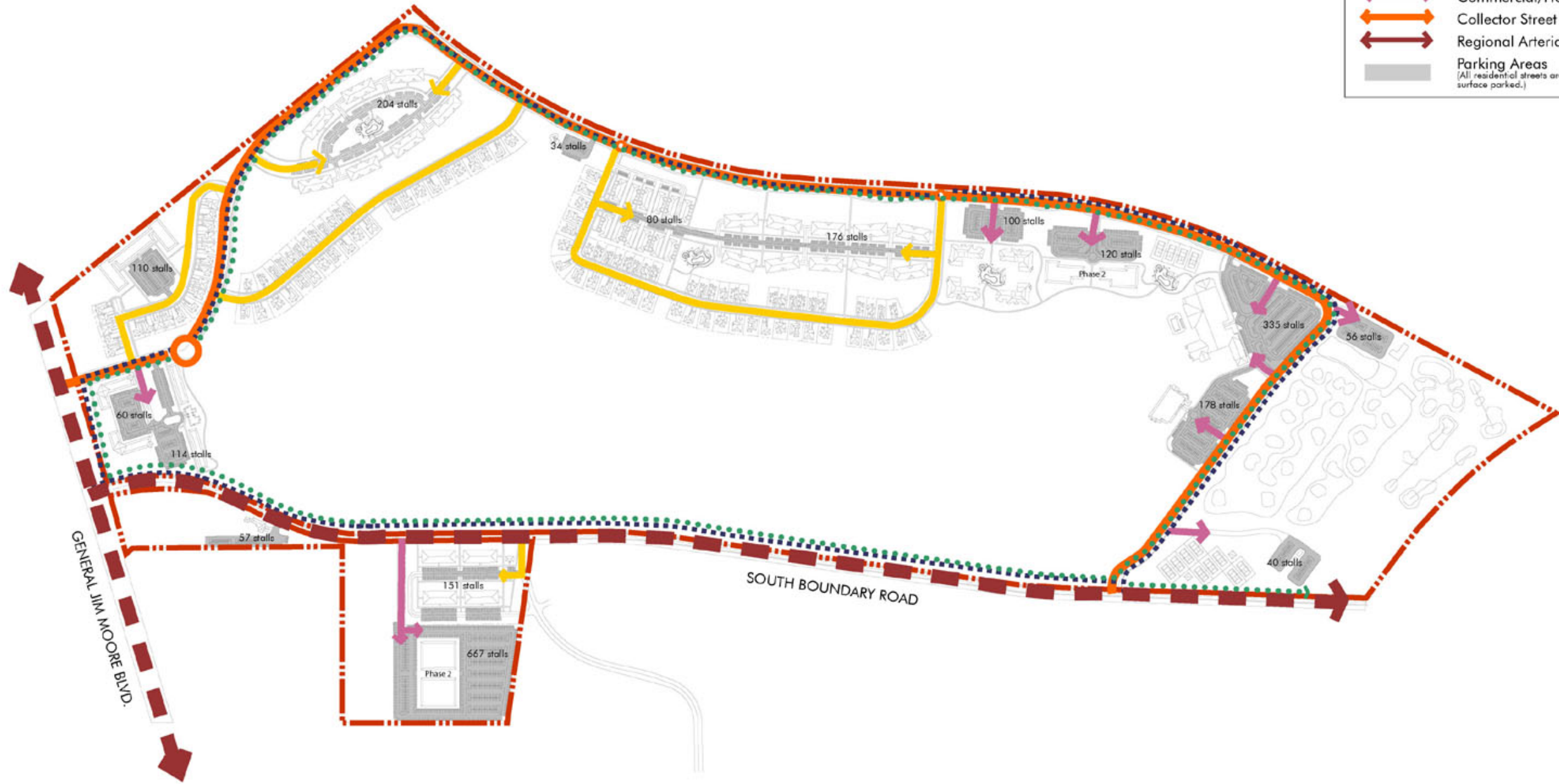

CIRCULATION AND PARKING PLAN

The Resort at Del Rey Oaks, Del Rey Oaks, CA

August 31, 2007 Project No. 315.001
DAHLIN GROUP
ARCHITECTURE
 PLANNING

5865 Owens Drive
 Pleasanton, CA 94588
 925.251.7200
 925.251.7201 fax 